



**RECORD OF TITLE
UNDER LAND TRANSFER ACT 2017
FREEHOLD
Search Copy**



R. W. Muir
Registrar-General
of Land

Identifier SA63C/427
Land Registration District South Auckland
Date Issued 30 July 1998

Prior References
SA58C/575

Estate Fee Simple
Area 710 square metres more or less
Legal Description Lot 25 Deposited Plan South Auckland
79526

Registered Owners
Jon Antony Frederick Robben and Marlene Olive Robben

Interests
Land Covenant in Transfer B532309.2 - 15.3.1999 at 10:57 am
Fencing Covenant in Transfer B532309.2 - 15.3.1999 at 10:57 am
8353014.3 Mortgage to ASB Bank Limited - 15.12.2009 at 3:06 pm

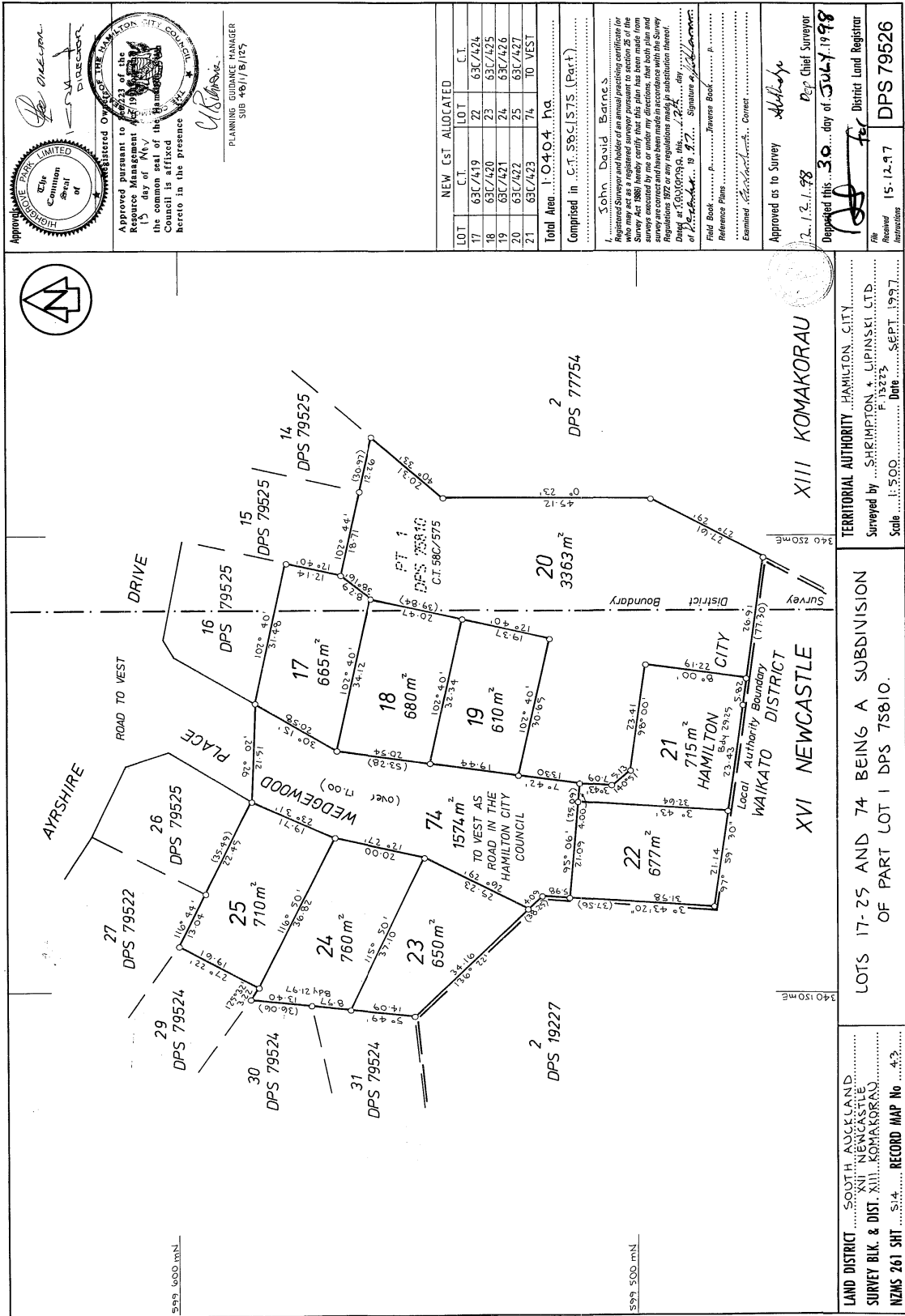

NEW CST ALLOCATED		
LOT	C.T.	LOT C.T.
17	63C/419	22 63C/424
18	63C/420	23 63C/425
19	63C/421	24 63C/426
20	63C/422	25 63C/427
21	63C/423	74 TO WEST

Total Area... 104,044 sq. m.
Comprising in C.T. 596,1575 (Part)

I, **John David Barnes**,
Registered Surveyor and holder of an annual practicing certificate for
who may act as a registered surveyor pursuant to section 85 of the
Survey Act 1986, hereby certify that this plan has been made from
survey or otherwise and has been made in accordance with the Survey
Regulations 1972 or any regulations made in substitution thereof.
Dated at **Hamilton, N.Z.** this **22nd** day of **July 1998**
or **22nd** day of **July 1998**. Signature of **John David Barnes**
Field Book.....
Reference Plans.....
Examined.....
Approved as to Survey.....
Deposited this **30th** day of **July 1998**
at the office of the District Land Registrar
DPS 79526

Approved as to Survey
Deposited this 30th day of July 1998
at the office of the District Land Registrar
DPS 79526

Approved pursuant to Section 177 of the Resource Management Act 1991 on this 15th day of May 1998
the common seal of the Hamilton City Council is affixed hereto in the presence
U.S. Barnes
PLANNING GUIDANCE MANAGER
SIB 481/18/1275

1:500 Date: SEPT 1997

XIII KOMAKORAU

XVI NEWCASTLE

WAIKATO DISTRICT

LOCAL AUTHORITY BOUNDARY

DISTRICT BOUNDARY

ROAD TO WEST

AYRSHIRE PLACE

WEDGEWOOD PLACE

ROAD TO WEST AS

ROAD IN THE HAMILTON CITY COUNCIL

HAMILTON CITY

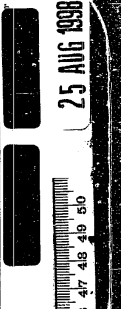

Scale 1:500 Date: SEPT 1997

XIII KOMAKORAU

XVI NEWCASTLE

WAIKATO DISTRICT

LOCAL AUTHORITY BOUNDARY

DISTRICT BOUNDARY

ROAD TO WEST

AYRSHIRE PLACE

WEDGEWOOD PLACE

ROAD TO WEST AS

ROAD IN THE HAMILTON CITY COUNCIL

HAMILTON CITY

LAND DISTRICT SOUTH AUCKLAND
SURVEY BLK. & DIST. XII, NEWCASTLE
NZMS 261 SH1 S.14 RECORD MAP No 43

LOTS 17-25 AND 74 BEING A SUBDIVISION OF PART LOT 1 DPS 78810.

TERRITORIAL AUTHORITY HAMILTON CITY

Surveyed by SHEMPINGTON & LIPINSKI LTD.

Scale 1:500 Date: SEPT 1997

XIII KOMAKORAU

XVI NEWCASTLE

WAIKATO DISTRICT

LOCAL AUTHORITY BOUNDARY

DISTRICT BOUNDARY

ROAD TO WEST

AYRSHIRE PLACE

WEDGEWOOD PLACE

ROAD TO WEST AS

ROAD IN THE HAMILTON CITY COUNCIL

HAMILTON CITY